

# RT18-32

Low voltage  
AC fuse



## Application

This series fuse is mainly used for protecting the electrical circuit against overload and short-circuits(gG/gL). Because of different melting tablets, it also may derive for protecting the semiconductor device and others complete set installment from short-circuit (aR/gR/gS/gtr) as well as the electric motor from short-circuit (aM).

## Structural Characteristics

- According to IEC60269-6
- Rated current: 1-32A
- Rated voltage: AC 380V/500V
- Cylindrical fuse

## Specification

Pole	1P,2P,3P
Rated Voltage Ue (V AC)	380V/500V
Rated Current In (A)	1, 2, 3, 4, 5, 6, 8, 10, 12,16, 20, 25, 32
Biggest Block Ability(KA)	100

## Connection and Installation

Working Temperature(°C)	-5~+40
Resistance And Damp Hot	Class 2
Altitude(m)	≤ 2000
Relative Humidity	≤ 95%
Protection Class/Degree	IP20
Pollution	3
Installation Environment	No obvious shock and vibration
Installation Class/Type	Class III/DIN rail

## Size(mm)

W*H*L	18x60x80
Fuse Size	10x38

## Dimensions(mm)

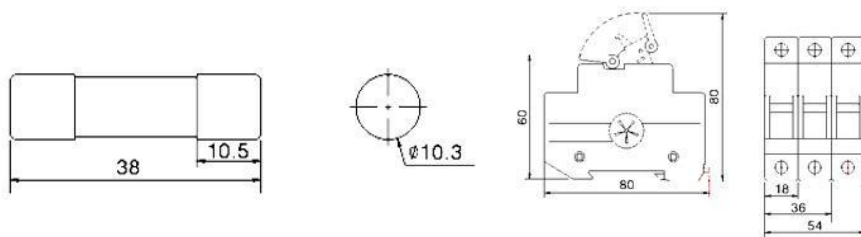

## Installation

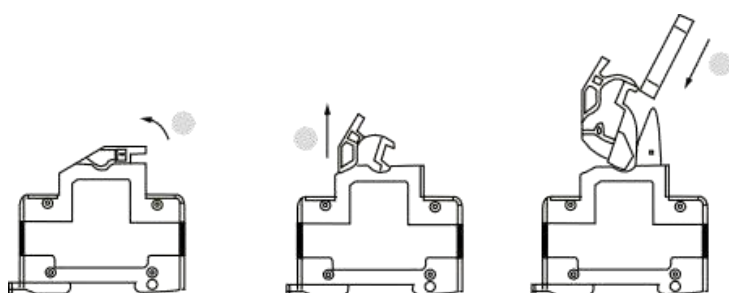

## Characteristic Curve

