



**MECHANICAL
ENGINEERING
PARTS
&
COMPONENTS**

FLEXIBLE SHAFT COUPLINGS



SPECIFICATIONS

| | |
|-----------------------|---|
| APPLICATIONS | Stepper motor & other motor shaft coupling |
| NOMINAL TORQUE | 50 N.m |
| MAX SPEED | 10,000 rpm |
| MATERIAL | Aluminium |
| MECAON REF | M08-000-01 TO M08-0001-23 |

DIMENSIONS TABLE

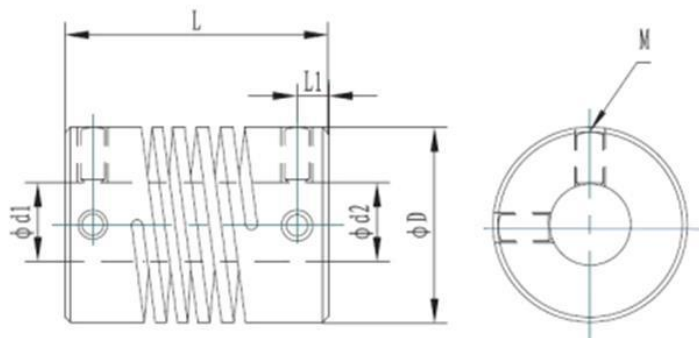

| REF | MODEL | DIMENSIONS IN mm | | | | |
|-----|--------|------------------|------|---------|------|------|
| | | d1 | d2 | M | D | L |
| 1 | 190016 | 3.0 | 3.0 | M4x0.75 | 19.0 | 25.0 |
| 2 | 190040 | 3.0 | 6.35 | M4x0.75 | 19.0 | 25.0 |
| 3 | 190041 | 4.0 | 4.0 | M4x0.75 | 19.0 | 25.0 |
| 4 | 190042 | 4.0 | 5.0 | M4x0.75 | 19.0 | 25.0 |
| 5 | 190043 | 4.0 | 6.0 | M4x0.75 | 19.0 | 25.0 |
| 6 | 190044 | 4.0 | 6.35 | M4x0.75 | 19.0 | 25.0 |
| 7 | 190045 | 4.0 | 8.0 | M4x0.75 | 19.0 | 25.0 |
| 8 | 190046 | 5.0 | 5.0 | M4x0.75 | 19.0 | 25.0 |
| 9 | 190047 | 5.0 | 6.0 | M4x0.75 | 19.0 | 25.0 |
| 10 | 190048 | 5.0 | 6.35 | M4x0.75 | 19.0 | 25.0 |
| 11 | 190049 | 5.0 | 7.0 | M4x0.75 | 19.0 | 25.0 |
| 12 | 190050 | 5.0 | 8.0 | M4x0.75 | 19.0 | 25.0 |
| 13 | 190051 | 6.0 | 6.0 | M4x0.75 | 19.0 | 25.0 |
| 14 | 190052 | 6.0 | 7.0 | M4x0.75 | 19.0 | 25.0 |
| 15 | 170691 | 6.0 | 8.0 | M4x0.75 | 19.0 | 25.0 |
| 16 | 181183 | 6.0 | 10.0 | M4x0.75 | 19.0 | 25.0 |
| 17 | 190056 | 6.35 | 6.35 | M4x0.75 | 19.0 | 25.0 |
| 18 | 190054 | 7.0 | 7.0 | M4x0.75 | 19.0 | 25.0 |
| 19 | 190055 | 7.0 | 8.0 | M4x0.75 | 19.0 | 25.0 |
| 20 | 190057 | 8.0 | 8.0 | M4x0.75 | 19.0 | 25.0 |
| 21 | 181184 | 8.0 | 12.0 | M4x0.75 | 19.0 | 25.0 |
| 22 | 190058 | 10.0 | 10.0 | M4x0.75 | 19.0 | 25.0 |
| 23 | 181185 | 10.0 | 12.0 | M4x0.75 | 19.0 | 25.0 |

Other dimensions are available on demand.