

CFPV-32

Solar DC Fuse



Application

A range of 10x38mm fuse links specifically designed for protecting photovoltaic strings. These fuse links are capable of interrupting low overcurrents associated with faulted photovoltaic string arrays (reverse current, multi-array fault).

Structural Characteristics

- According to IEC60269-6
- Rated current: 1-32A
- Rated voltage: DC 1000V
- Interrupting capacity: DC20kA
- Operating class gPV for Solar protection

Specification

Pole	1P
Rated Voltage U_e (V DC)	1000
Rated Current I_n (A)	1, 2, 3, 4, 5, 6, 8, 10, 12, 16, 20, 25, 32

Connection and Installation

Connection (mm ²)	2.5 -10
Working Temperature (°C)	-30~+70
Resistance And Damp Hot	Class 2
Altitude (m)	≤ 2000
Relative Humidity	≤ 95%
Protection Class/Degree	IP20
Pollution	3
Installation Environment	No obvious shock and vibration
Installation Class/Type	Class III/DIN rail

Size (mm)

W*H*L	18x60x80
Fuse Size	10x38
Weight (kg)	0.07

PV Fuse Description

- Photovoltaic system fuse accord with UL248-1standard.
- Photovoltaic battery dc fuse designed to used for photovoltaic (PV) system.
- Main effect is to protect the solar panels. Solar panels points in effective condition is broken.
- Fault light cells break points at the same time, does not affect other normal work of light from the stack.
- Technical Data Rated coltage: DC1000V Breaking capacity: 20KA Function level: PV

Dimensions(mm)

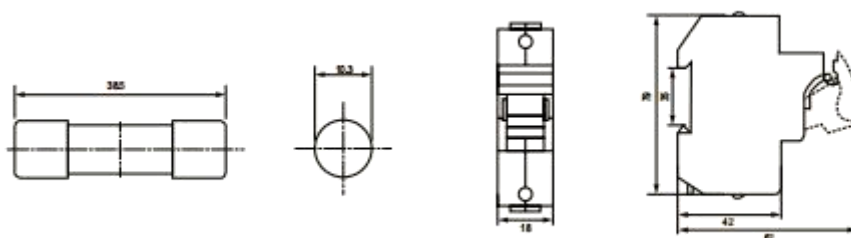

Installation

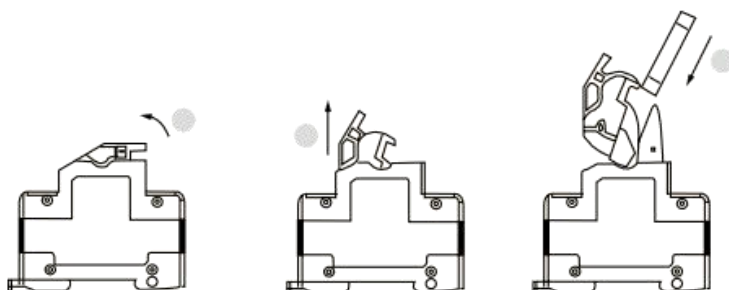

Characteristic Curve

